

# PRIKLJUČCI ZA NISKOTLAČNE GUMENE OPLETENE CIJEVI ZA NAFTU, NAFTNE DERIVATE I HIDRAULICNO ULJE

PRIKLJUČAK | MATERIJAL | NAPOMENA

A M - NO		
A M10x1 - NO 6	Ms-Fe/Zn	
A M12x1,5 - NO 6	Ms-Fe/Zn	
A M12x1,5 - NO 8	Ms-Fe/Zn	
A M14x1,5 - NO 6	Ms-Fe/Zn	
A M14x1,5 - NO 8	Ms-Fe/Zn	
A M16x1,5 - NO 8	Ms-Fe/Zn	
A M16x1,5 - NO 10	Ms-Fe/Zn	
A M18x1,5 - NO 10	Ms-Fe/Zn	
A M18x1,5 - NO 13	Fe/Zn	

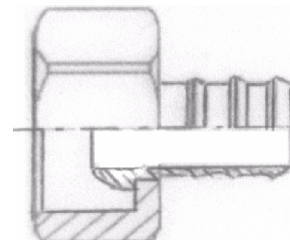

A R bm - NO		bez matice
A R 1/8" bm - NO 6	Ms	
A R 1/4" bm - NO 6	Ms	
A R 1/4" bm - NO 8	Ms	
A R 3/8" bm - NO 6	Ms	
A R 3/8" bm - NO 8	Ms	
A R 3/8" bm - NO 10	Ms	
A R 1/2" bm - NO 8	Ms	
A R 1/2" bm - NO 10	Ms	
A R 1/2" bm - NO 13	Ms	
A R 1/2" bm - NO 16	Ms	
A R 3/4" bm - NO 13	Ms	
A R 3/4" bm - NO 16	Ms	
A R 3/4" bm - NO 19	Ms	
A R 1" bm - NO 25	Ms	
A R 1.1/4" bm - NO 32	Fe/Zn	

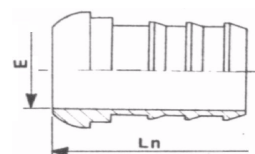

A R bm L90 NO		bez matice
A R 1/4" bm L90 NO 6	Fe/Zn	
A R 1/4" bm L90 NO 8	Ms/Ni	
A R 3/8" bm L90 NO 8	Ms/Ni	
A R 3/8" bm L90 NO 10	Ms/Ni	
A R 1/2" bm L90 NO 10	Ms/Ni	
A R 1/2" bm L90 NO 13	Ms/Ni	
A R 1/2" bm L90 NO 16	Ms/Ni	
A R 3/4" bm L90 NO 16	Ms/Ni	
A R 3/4" bm L90 NO 19	Ms/Ni	
A R 1" bm L90 NO 25	Ms/Ni	

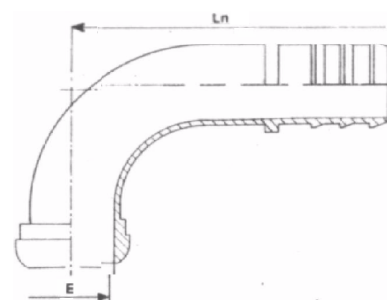

B (M) - NO	Fe/Zn	
B 8 - NO 6	Fe/Zn	
B 10 - NO 6	Fe/Zn	
B 10 - NO 8	Fe/Zn	
B 12 - NO 6	Fe/Zn	
B 12 - NO 8	Fe/Zn	
B 14 - NO 6	Fe/Zn	
B 14 - NO 8	Fe/Zn	
B 14 - NO 10	Fe/Zn	
B 14 - NO 13	Fe/Zn	
B 16 - NO 10	Ms	
B 16 - NO 10	Fe/Zn	

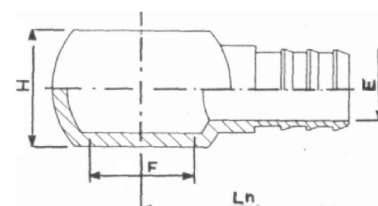

J1 M - NO	Fe/Zn
J1 M12x1,5 - NO 6	Fe/Zn
J1 M14x1,5 - NO 6	Fe/Zn
J1 M14x1,5 - NO 8	Fe/Zn
J1 M16x1,5 - NO 8	Fe/Zn
J1 M16x1,5 - NO 10	Fe/Zn
J1 M18x1,5 - NO 10	Fe/Zn

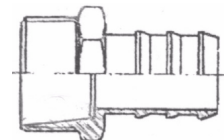

Priključak	MATICA R	Ms/Ni
A R1/4" bm NO 6, 8	Matica R 1/4" ( 9,5x13,5)	Ms/Ni
A R3/8" bm NO 6, 8, 10	Matica R 3/8" (13,0x15,0)	Ms/Ni
A R1/2" bm NO 8	Matica R 1/2" (14,5x14,0)	Ms/Ni
A R1/2" bm NO 10,13,16	Matica R 1/2" (16,3x14,0)	Ms/Ni
A R3/4" bm NO 13	Matica R 3/4" (19,0x14,0)	Ms/Ni
A R3/4" bm NO 16, 19	Matica R 3/4" (21,5x16,0)	Ms/Ni
A R1" bm NO 25	Matica R1" (27,5x17,0)	Ms/Ni
A R1.1/4" bm NO 25, 32	Matica R1.1/4" (35,5x18,0)	Ms/Ni

Ø D	H	OK
9,5	13,5	17
13,0	15,0	20
14,5	14,0	24
16,3	14,0	24
19,0	14,0	29
21,5	16,0	30
27,5	17,0	37
35,5	18,0	46

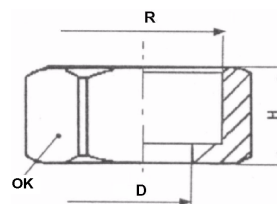

- Napomene:**
- Za naftu, naftne derivate i hidrauliku se mogu koristiti i pojedini priključci navedeni u cjenicima priključaka za niskotlačne gumene opletene cijevi za plinove, odnosno toplu vodu.
  - Ako se prilikom naručivanja ne naglasi od kojeg se materijala želi niskotlačne priključke B 16 - NO 10 biti će isporučeni oni priključci koje trenutno imamo na skladištu.
  - Kod naručivanja svih matica treba obavezno naznačiti pored navoja i promjer rupe D i visinu matice H (pritom se pripadajući OK vidi iz gornje tablice) ili za koju nogicu i namjenu su predviđene.