

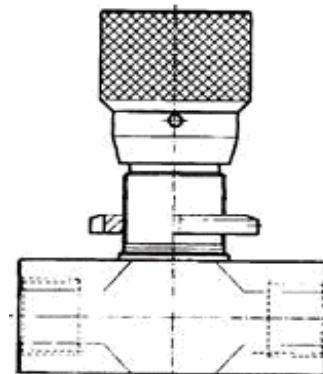

VENTILI RUČNI VISOKOTLAČNI REDUKCIONI

RADNI TLAK | VRSTA VENTILA | SIMBOL

	Prigušni	
400 bara	VRV P L90K U R1/4"	
400 bara	VRV P L90K U R3/8"	
400 bara	VRV P L90K U R1/2"	
400 bara	VRV P L90K U R3/4"	



	Nepovratni kuglasti	
400 bara	VRV NK - U R1/8"	
400 bara	VRV NK - U R1/4"	
400 bara	VRV NK - U R3/8"	
350 bara	VRV NK - U R1/2"	
300 bara	VRV NK - U R3/4"	
250 bara	VRV NK - U R1"	
250 bara	VRV NK - U R1.1/4"	
250 bara	VRV NK - U R1.1/2"	
200 bara	VRV NK - U R2"	

	Nepovratni igličasti	
400 bara	VRV NI - U R1/4"	
400 bara	VRV NI - U R3/8"	
350 bara	VRV NI - U R1/2"	
300 bara	VRV NI - U R3/4"	
300 bara	VRV NI - U R1"	
250 bara	VRV NI - U R1.1/4"	
230 bara	VRV NI - U R1.1/2"	

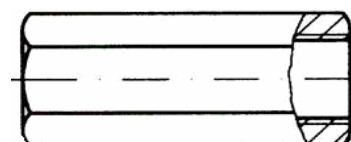

	Prigušni nepovratni kuglasti	
300 bara	VRV PNK - U R1/4"	
300 bara	VRV PNK - U R3/8"	
250 bara	VRV PNK - U R1/2"	
250 bara	VRV PNK - U R3/4"	
250 bara	VRV PNK - U R1"	



	Prigušni nepovratni igličasti	
370 bara	VRV PNI - U R1/4"	
370 bara	VRV PNI - U R3/8"	
370 bara	VRV PNI - U R1/2"	

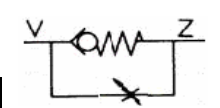

	Prigušni nepovratni igličasti	
400 bara	VRV PNI L90K U R1/4"	
400 bara	VRV PNI L90K U R3/8"	
400 bara	VRV PNI L90K U R1/2"	
400 bara	VRV PNI L90K U R3/4"	
400 bara	VRV PNI L90K U R1"	

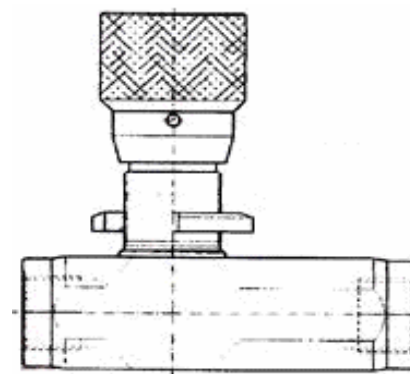
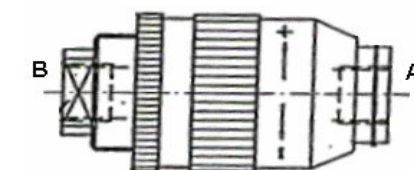

Napomene: * Ako se ovi nepovratni ventili žele koristiti kao prelivni treba ih zasebno naručiti sa oprugama koje imaju tlak otvaranja od 3 bara ili 6 bara (umjesto standardnih 0,5 bara).

- Podatke o dimenzijama i protocima pojedinih redukcionih ventila moguće je dobiti na upit.